

Whitton



Offered for sale is this spacious detached bungalow situated on an extremely large plot with excellent potential to extend (subject to planning permission). Comprising two double bedrooms, gas central heating, double glazing, conservatory and detached garage. The property requires slight updating. Viewings highly recommended.

£ 279,950 Freehold



Hanworth Road

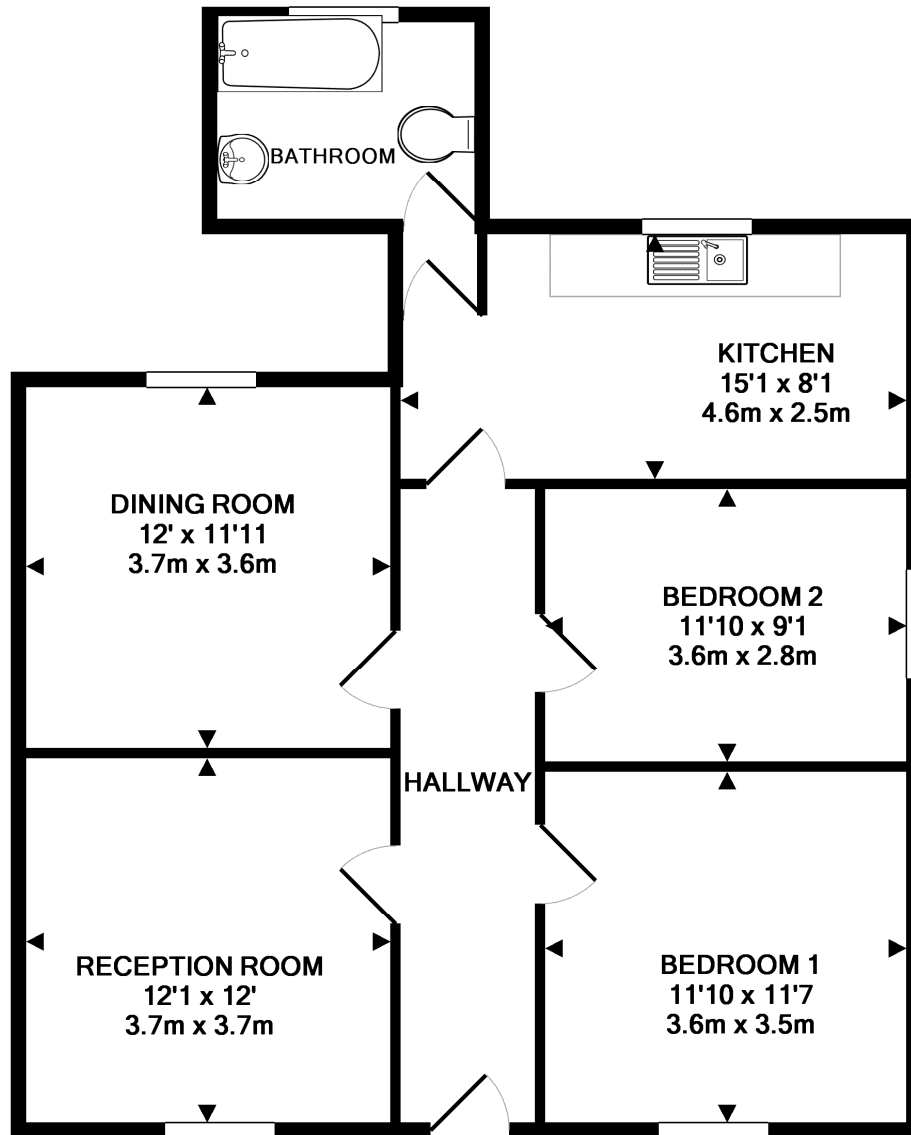

TOTAL APPROX. FLOOR AREA 818 SQ.FT. (76.0 SQ.M.)

Whilst every attempt has been made to ensure the accuracy of the floor plan contained here, measurements of doors, windows, rooms and any other items are approximate and no responsibility is taken for any error, omission, or mis-statement. This plan is for illustrative purposes only and should be used as such by any prospective purchaser. The services, systems and appliances shown have not been tested and no guarantee as to their operability or efficiency can be given

Made with Metropix ©2011

Please note that i

The buyer is advised to obtain verification from their solicitor or surveyor.

in working order.

Whilst we endeavor to make our sales details accurate and reliable, if there is any point, which is of particular importance to you, please contact the office and we will be pleased to verify any information for you. All measurements have been taken by a sonic tape and should not be relied upon for their accuracy, and could be subject to a small margin of error.

For a free valuation, call now! T 020 8755 2666