

Whitton



Offered for sale is this extended end of terrace family home located in a popular residential road. Comprising three bedrooms, double glazing, gas central heating, approximately 17ft kitchen, good size through lounge, modern fitted bathroom, attractive rear garden and garage. Viewings highly recommended,

£329,950 Freehold.



Grasmere Avenue

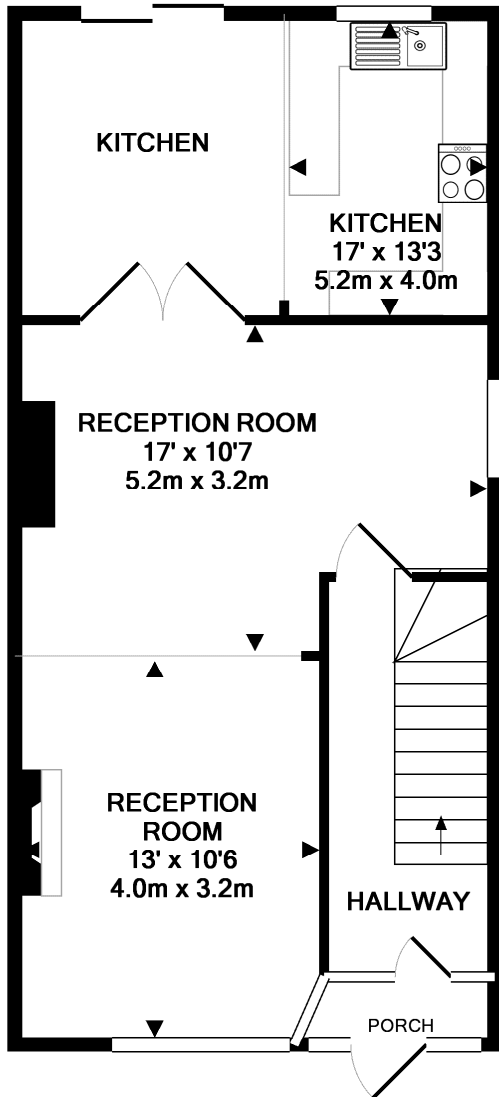

GROUND FLOOR
APPROX. FLOOR
AREA 530 SQ.FT.
(49.2 SQ.M.)

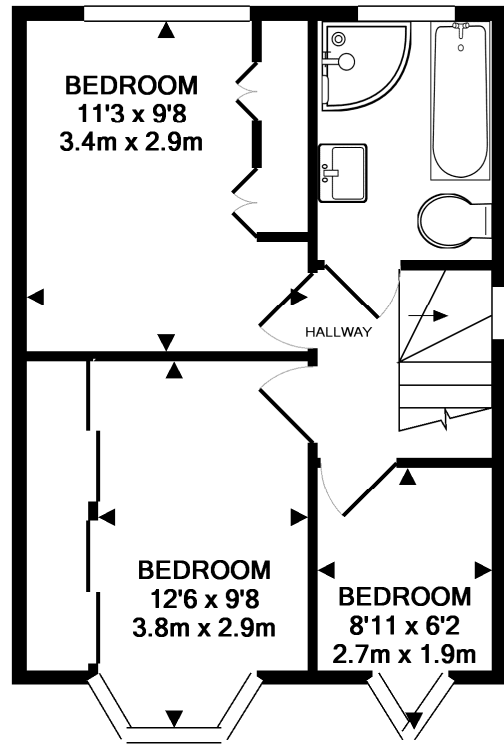

1ST FLOOR
APPROX. FLOOR
AREA 355 SQ.FT.
(33.0 SQ.M.)

TOTAL APPROX. FLOOR AREA 885 SQ.FT. (82.2 SQ.M.)

Whilst every attempt has been made to ensure the accuracy of the floor plan contained here, measurements of doors, windows, rooms and any other items are approximate and no responsibility is taken for any error, omission, or mis-statement. This plan is for illustrative purposes only and should be used as such by any prospective purchaser. The services, systems and appliances shown have not been tested and no guarantee as to their operability or efficiency can be given

Made with Metropix ©2012

Please

The buyer is advised to obtain verification from their solicitor or surveyor.

order.

Whilst we endeavor to make our sales details accurate and reliable, if there is any point, which is of particular importance to you, please contact the office and we will be pleased to verify any information for you. All measurements have been taken by a sonic tape and should not be relied upon for their accuracy, and could be subject to a small margin of error.

For a free valuation, call now! T 020 8755 2666