

# Hanworth



A well presented and extended end of terrace property conveniently located for all local amenities and bus routes. Comprising three bedrooms, gas central heating, double glazing, garage to rear, superb kitchen breakfast room plus large lounge diner. Viewings highly recommended.

**£229,950 Freehold.**



# Sunningdale Avenue

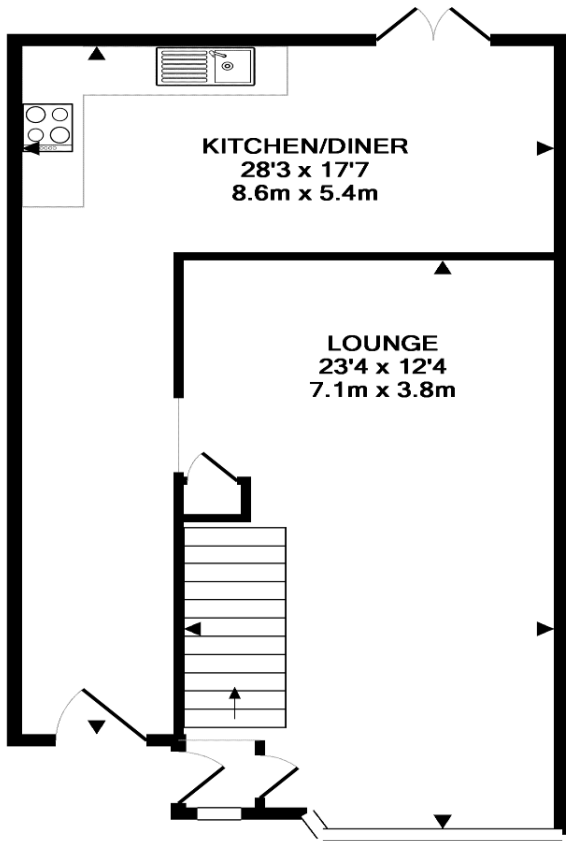

GROUND FLOOR  
APPROX. FLOOR  
AREA 541 SQ.FT.  
(50.3 SQ.M.)

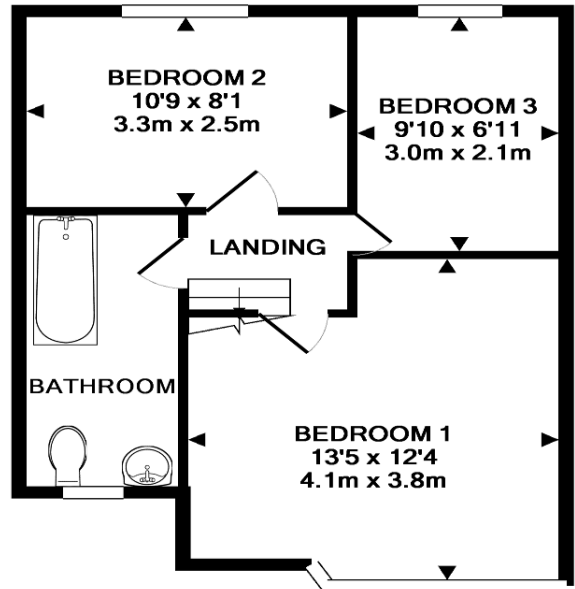

1ST FLOOR  
APPROX. FLOOR  
AREA 385 SQ.FT.  
(35.8 SQ.M.)

**TOTAL APPROX. FLOOR AREA 927 SQ.FT. (86.1 SQ.M.)**

Whilst every attempt has been made to ensure the accuracy of the floor plan contained here, measurements of doors, windows, rooms and any other items are approximate and no responsibility is taken for any error, omission, or mis-statement. This plan is for illustrative purposes only and should be used as such by any prospective purchaser. The services, systems and appliances shown have not been tested and no guarantee as to their operability or efficiency can be given  
Made with Metropix ©2012

Please note that it is not our policy to test services, heating systems and domestic appliances and we cannot verify that they are in working order. The buyer is advised to obtain verification from their solicitor or surveyor.

Whilst we endeavor to make our sales details accurate and reliable, if there is any point, which is of particular importance to you, please contact the office and we will be pleased to verify any information for you. All measurements have been taken by a sonic tape and should not be relied upon for their accuracy, and could be subject to a small margin of error.

**For a free valuation, call now! T 020 8831 9290**